

Installation instructions

SOLITEX FRONTA® QUATTRO FB

Installation steps



1. Install the membrane

Roll out the membrane and use galvanised staples that are at least 10 mm ($\frac{3}{8}$ ") wide by 8 mm ($\frac{5}{16}$ ") long to fasten the membrane in the overlap area at intervals of 10–15 cm (4"–6") in a manner that protects against moisture entry. Install the membrane leaving an additional 4 cm ($1\frac{1}{8}$ ") overlap at adjacent building structures so that a windtight bond can be applied here subsequently.



2. Apply double-sided adhesive tape

Clean the subsurface (dry and free of dust, silicone and grease), stick DUPLEX double-sided adhesive tape to the lower third of the subsequent overlap in a manner that protects against moisture. Rub the tape firmly using the PRESSFIX to secure the adhesive bond. Ensure that there is sufficient resistance pressure.



3. Overlap the membranes

Overlap the membranes for at least 10 cm (4") so that they are watertight. The printed markings on the membrane serve as a guide here.



4. Taping over the overlaps

Gradually remove the release film from DUPLEX and stick the overlapping membrane, ensuring that there are no folds or tension. Rub the tape firmly using the PRESSFIX to secure the adhesive bond. Ensure that there is sufficient resistance pressure.



5a. Alternatively: Taping over the overlaps with TESCON INVIS

Tape TESCON INVIS system adhesive tape centrally to the overlap and stick it down bit by bit so that it is load and wrinkle free.



5b. Alternatively: Taping over the overlaps with TESCON INVIS

Rub the tape firmly using the PRESSFIX to secure the adhesive bond. Ensure that there is sufficient resistance pressure.



6a. Sealing to rough or mineral surfaces (e.g. floorboard)

Clean the surface. Apply a bead of ORCON F adhesive sealant – at least 5 mm (3/16”) thick (more in the case of very rough surfaces).



6b. Sealing to rough or mineral surfaces (e.g. floorboard)

Apply the membrane, leaving slack to allow for expansion, and do not press the adhesive completely flat to allow for relative motion between components.

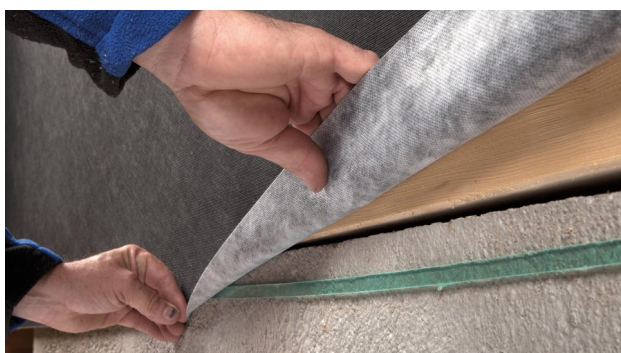

7. Alternatively: Sticking to rough or mineral surfaces (e.g. floorboard)

Stick line of adhesive to the subsurface, remove release film and stick the membrane in place, leaving slack to allow for expansion.



8a. Sealing around windows

Install membranes continuously over window openings and attach them all around the window using a stapler. Then cut open the opening using a utility knife.

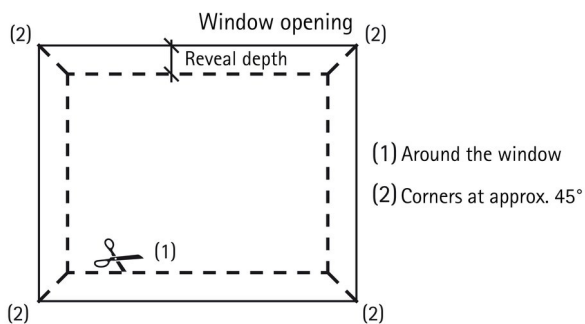

8b. Sealing around windows

In the case of recessed windows, cut into the membrane as shown in the sketch and guide into the reveal as far as the window frame.

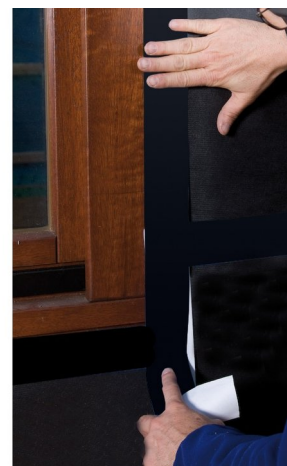
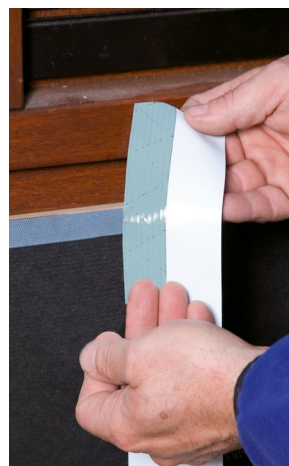

9. Sealing around windows

Tape the membrane to the window frame using TESCON PROTECT to ensure a windtight seal. Thanks to the split release paper it is possible to stick the tape first to the membrane and then, subsequently, to the window. Alternatively use TESCON VANA or TESCON INVIS.



10. Sealing cable and pipe penetrations

Fit a KAFLEX or ROFLEX 15-30 mm (1/2"-13/16") sealing grommet over the cable or pipe and tape it to the membrane. The plain black variants of the KAFLEX and ROFLEX sealing grommets are well-suited for open-jointed cladding due to their discreet colour. Alternative method: use blue grommets and tape over them with TESCON INVIS. Stick non-self-adhesive pipe grommets to the membrane using TESCON INVIS.

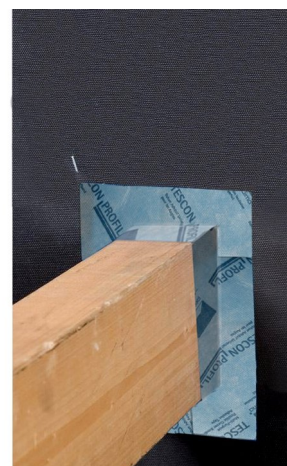

11. Sealing angular penetrations

Slide the TESCON PROTECT pre-folded corner sealing tape into the corner on the release film and stick the first independent adhesive strip. Then remove the remaining release strips and stick the second side. Alternatively, this transition can be sealed using the black TESCON INVIS adhesive tape.

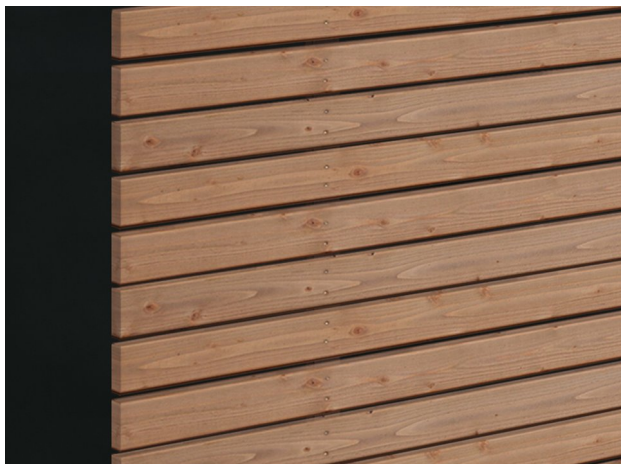

12. Installation of decking

Horizontal or vertical installation of decking –

SOLITEX FRONTA WA: Only for closed decking

SOLITEX FRONTA QUATTRO: For open cladding with gap widths up to max. 35 mm (1 $\frac{3}{8}$ "

SOLITEX FRONTA QUATTRO FB: Flame-resistant

SOLITEX FRONTA PENTA: For open cladding with gap widths up to max. 50 mm (2")

General conditions

SOLITEX FRONTA QUATTRO FB membranes should be installed with the black side facing outwards. The membranes are to be installed horizontally in a taut manner with no sagging.

When the product is used behind open-jointed cladding, the gap may be a maximum of 35 mm (1 $\frac{3}{8}$ "). The width of cladding pieces must be at least three times the gap width. The distance between the open-jointed cladding and the membrane must be at least 20 mm ($\frac{3}{4}$ ").

Fasteners may not be applied in areas where water run-off is collected.

Additional measures (e.g. covering with tarpaulins) should be taken during the construction phase in the case of buildings that are lived in or buildings that are to be given particular protection. Covering with tarpaulins should also be considered if construction work is to be interrupted for a longer period.

The information provided here is based on practical experience and the current state of knowledge. We reserve the right to make changes to the recommended designs and processing or to make alterations due to technical developments and associated improvements in the quality of our products. We would be happy to inform you of the current technical state of the art at the time you use our products.

Further information about installation and design details is available in the pro clima planning documentation. If you have any questions, please contact [pro clima Technical Support](<https://proclima.com/service/technical-support>).

MOLL

bauökologische Produkte GmbH

Rheintalstraße 35 - 43

D-68723 Schwetzingen

Fon: +49 (0) 62 02 - 27 82.0

eMail: info@proclima.de