

# Installation instructions

## SOLITEX FRONTA® WA

### Installation steps



#### 1. Install the membrane

Roll out the membrane and use galvanised staples that are at least 10 mm (3/8") wide by 8 mm (5/16") long to fasten the membrane in the overlap area at intervals of 10-15 cm (4"-6") in a manner that protects against moisture entry. Install the membrane leaving an additional 4 cm (1 5/8") overlap at adjacent building components so that a windtight bond can be applied here subsequently.

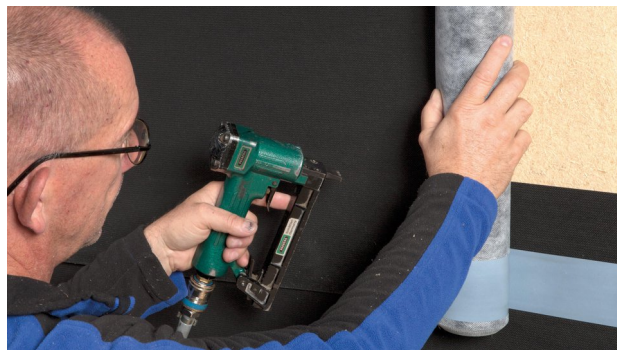

#### 2. Overlap the membranes

Clean the subsurface (dry and free of dust, silicone and grease). Overlap the membranes by approx. 10 cm (4") so that they are watertight. The printed markings are an aid to orientation.



#### 3. Stick overlaps using 'connect' adhesion technology

Stick membrane overlaps in the case of 'connect' membranes with two integrated self-adhesive strips. Rub the stuck joint firmly using the pro clima PRESSFIX. Ensure that there is sufficient resistance pressure.



#### 4. Alternatively: Taping over the overlaps with TESCON INVIS

Tape TESCON INVIS system adhesive tape centrally to the overlap and stick it down bit by bit so that it is load and wrinkle free. Rub tape firmly into place using the pro clima PRESSFIX. Ensure that there is sufficient resistance pressure.





**5. Sticking to rough or mineral surfaces (e.g. floorboard)**

Clean the surface. Apply a bead of ORCON F system adhesive – at least 5 mm (3/16") thick (more in the case of very rough surfaces). Lay the membrane with an expansion joint and not pressing the tape down completely to allow for movement of the parts.

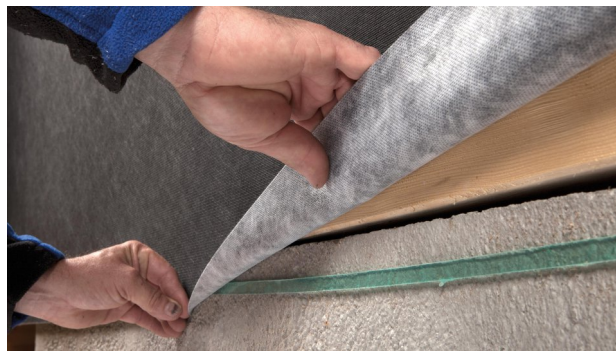

**6. Alternatively: Sticking to rough or mineral surfaces (e.g. floorboard)**

Stick line of adhesive to the subsurface, remove release film and stick the membrane in place, leaving slack to allow for expansion.

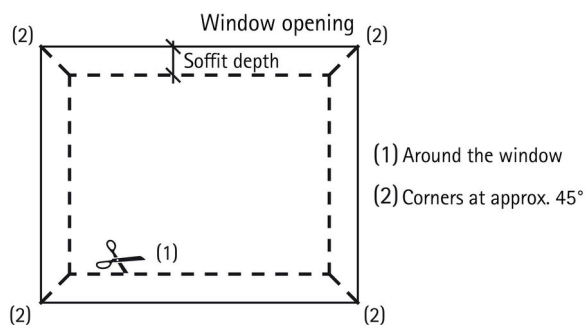

**7. Sticking to windows**

In the case of recessed windows, cut into the membrane as shown in the sketch and guide into the reveal as far as the window frame.



**8. Sticking to windows**

Stick the membrane to the window frame so that it is windtight using TESCON PROTECT. Thanks to the split release paper it is possible to stick the tape first to the membrane and then, subsequently, to the window. Alternatively, use TESCON INVIS.



**9. Sticking to cables and pipes**

Place KAFLEX or ROFLEX sealing grommets over the cable or pipe and stick to the membrane. In the case of large gap widths, stick over the blue cable grommet using TESCON INVIS. Tape the pipe grommets to the membrane with TESCON INVIS.

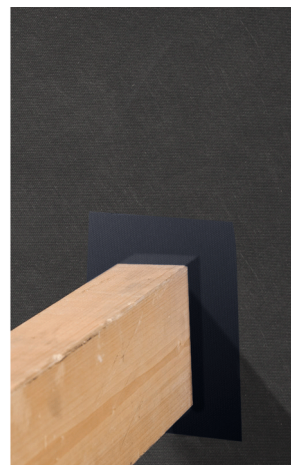
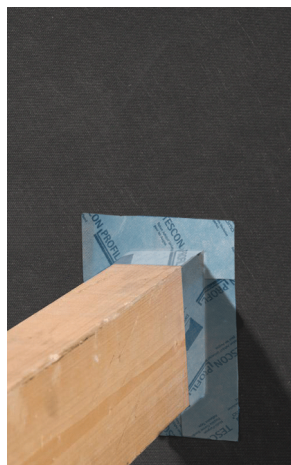

**10. Seal angular penetrations**

Slide the TESCON PROTECT pre-folded corner sealing tape into the corner on the release film and stick the first independent adhesive strip. Then remove the remaining release strips and stick the second side. Alternatively, this transition can be sealed using the black TESCON INVIS adhesive tape.

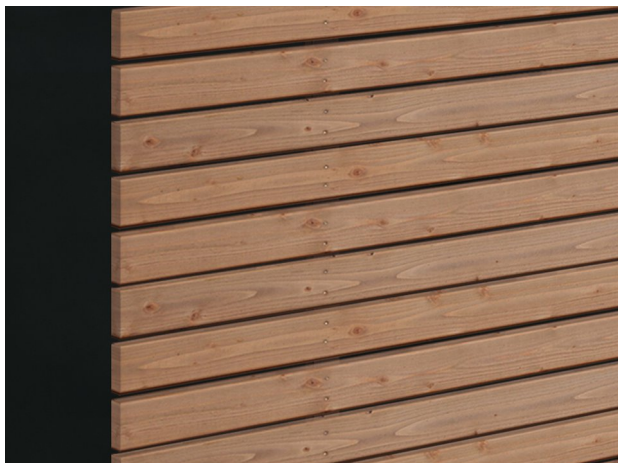

## 11. Installation of decking

Horizontal or vertical installation of decking –

SOLITEX FRONTA WA: Only for closed decking

SOLITEX FRONTA QUATTRO: For open cladding with gap widths up to max. 35 mm (1 3/8")

SOLITEX FRONTA QUATTRO FB: Flame-resistant

SOLITEX FRONTA PENTA: For open cladding with gap widths up to max. 50 mm (2")

## General conditions

SOLITEX FRONTA WA membranes are to be installed horizontally in a taut manner with no sagging.

The membrane must not be secured in areas where water collectively drains off.

The membrane can be used behind closed facades with at least 20 mm (1") of rear ventilation.

Additional measures (e.g. covering with tarpaulins) should be taken during the construction phase in the case of buildings that are lived in or buildings that are to be given particular protection. Covering with tarpaulins should also be considered if construction work is to be interrupted for a longer period.

---

The information provided here is based on practical experience and the current state of knowledge. We reserve the right to make changes to the recommended designs and processing or to make alterations due to technical developments and associated improvements in the quality of our products. We would be happy to inform you of the current technical state of the art at the time you use our products.

Further information about installation and design details is available in the pro clima planning documentation. If you have any questions, please contact [pro clima Technical Support](<https://proclima.com/service/technical-support>).

---

### MOLL

**bauökologische Produkte GmbH**

Rheintalstraße 35 - 43

D-68723 Schwetzingen

Phone: +49 (0) 62 02 - 27 82.0

E-mail: [info@proclima.com](mailto:info@proclima.com)